

Supplied by
nuplex

Construction Products

Free Phone: 0508 88 22 88

Free Fax: 0508 55 33 44

www.nuplexconstruction.co.nz

89/851E

CL/SB

(47)

Ln2

June 1989

SOPREMA®

HIGH TECHNOLOGY ROOF WATERPROOFING SYSTEMS

NON ACCESSIBLE
ROOF WITH
INSULATION

METAL DECK
WITH
INSULATION

COLOURED
ROOF

SOPRAJOINT
EXPANSION
JOINTS

CONCRETE
DECK

TIMBER
DECK

PEDESTRIAN
TERRACE

PARKING
DECK

ROOF-TOP
GARDEN

CONTENTS

————— PAGE 3 —————

FIRM FOUNDATIONS FOR FLAT ROOF EXPERIENCE

————— PAGE 4 —————

PRODUCTION FACILITIES FOR WORLD DEMAND

————— PAGE 5 —————

RESEARCH & DEVELOPMENT

————— PAGE 6 —————

TECHNICAL EXPERTISE

————— PAGE 7-8 —————

SOPREMA SBS MEMBRANES FOR UK

————— PAGE 9-11 —————

TECHNICAL DATA

————— PAGE 12-17 —————

DETAILS FOR SPECIFYING SOPREMA MEMBRANES

————— PAGE 18 —————

GUARANTEES

————— PAGE 18 —————

REFERENCES

FIRM FOUNDATIONS FOR FLAT ROOF EXPERIENCE

The SOPREMA GROUP was founded as L'usine Alsacienne d'Emulsions in Strasbourg, France, in 1908 by Charles Geisen, the inventor of the Mammoth membrane. His original concept paved the way for the development of modern waterproof membranes as we know them.

The current President of the Group is Pierre Geisen, an acknowledged world expert on roofing technology who has continued the work started by his father, thereby ensuring SOPREMA remains at the forefront of innovation and development.



Pierre GEISEN, President ►

In 1976 SOPREMA launched elastomeric membranes with heavy non-woven polyester reinforcement.

In 1982 came SOPRALENE FLAM, a range of SBS torch-on membranes with easily flammable film surfacing.

SOPREMA works closely with specifiers and contractors which has resulted in benefits for everyone. To allow the specifier to provide optimum function with aesthetic appeal there is a range of 8 standard colour finishes as well as copper, aluminium and stainless steel foil-faced membranes.

The roofer now has the facility to work standing up, using an attache-case torch-on kit and SOPREMA torch-on products. This is especially appreciated where access is difficult and it eliminates the need to bring heavy equipment on the roof.

SOPREMA has manufacturing plants and distribution in many countries and a worldwide turnover in excess of £ 120 million.

PRODUCTION FACILITIES FOR WORLD DEMAND



Plant and head-office in Strasbourg



Plant in Avignon



Plant in Louviers



Plant in Zurich - Switzerland



Plant in Drummondville - Canada

Now 80 years of bituminous waterproofing technology is available in the U.K., through Soprema (UK) Limited, a wholly-owned subsidiary of Soprema SA. With the marketing headquarters and distribution based at the hub of the motorway network, a full service is available to specifiers and contractors throughout Great Britain.

RESEARCH & DEVELOPMENT BRINGS INNOVATION WITH RELIABILITY

In an industry where many companies prefer to copy existing products or buy private label from other manufacturers, SOPREMA spends a vast amount on product development and evaluation.

Much of this budget is allocated to simulate ageing and deformation, and SOPREMA have formulated experimental procedures and controls which have been adopted as standards in the waterproofing industry. Such innovations make SOPREMA a leader in the technological development of high performance roofing.



Automatic Ring and Ball test.



Chromatographic analysis of elastomeric bitumen.



Computer aided identification and control of polymers.

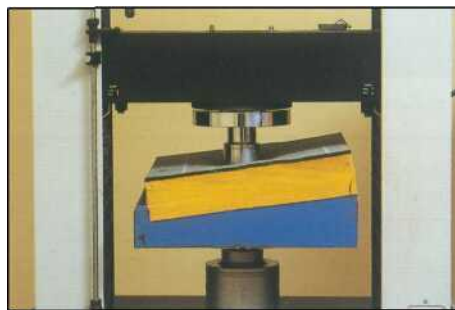

Static puncture test.



Test for resistance to dynamic indentation.

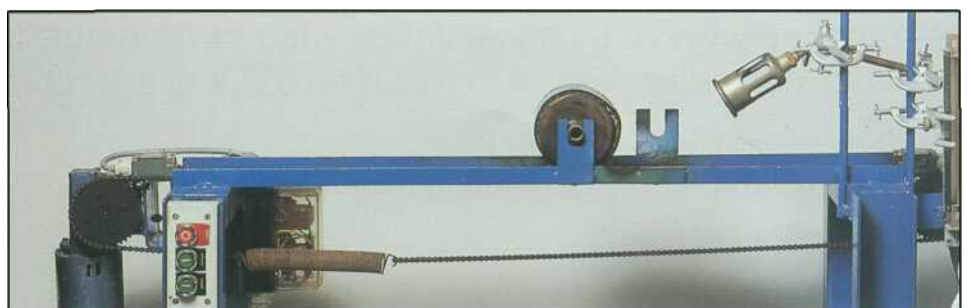

Test for torching.

TECHNICAL EXPERTISE BRINGS PRACTICAL ADVANTAGES

Styrene - Butadiene - Styrene (SBS)

No company has more experience in SBS bitumen technology than SOPREMA. Modifying bitumen with SBS polymers needs expertise and control. The result is the formation of a continuous network of bonds within the bitumen.

This gives SOPREMA waterproofing membranes great elasticity. In addition, the SBS bitumen is not prematurely aged by oxidation and provides improved performance in all climatic conditions.

Unlike APP products, SOPREMA SBS membranes are elastic and remain easy to work at temperatures down to - 30° C, making them ideal for the extremes of the British climate.

Nonwoven Polyester (NWP)

In 1976, SOPREMA introduced non woven polyester to their SBS membranes. Development work at Strasbourg had been concentrated on answering the increasingly stringent requirements of the building industry. Of particular concern were the stresses imposed on membranes by insulation materials, which increasingly formed the immediate substrate.

The non woven polyester used by SOPREMA withstands repeated movements and thermal stresses and gives considerable resistance to puncturing and fatigue.

SOPREMA NWP forms a perfect union with the SBS, each complimenting the strengths of the other in the SOPRALENE range, for pour and roll or torch-on.

Glass Fleece for efficiency with economy.

As an alternative carrier for the SBS bitumen, SOPREMA have developed a range of membranes using a glass fleece base. There will be specifications which do not require the luxury of two layers of NWP-based membranes.

The SOPREMA ELASTOPHENE range can be used to form one or both layers in the system and are compatible with SOPRALENE membranes.

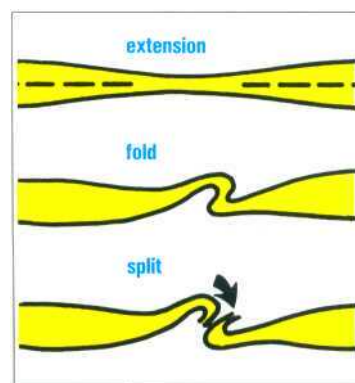

Ordinary membranes

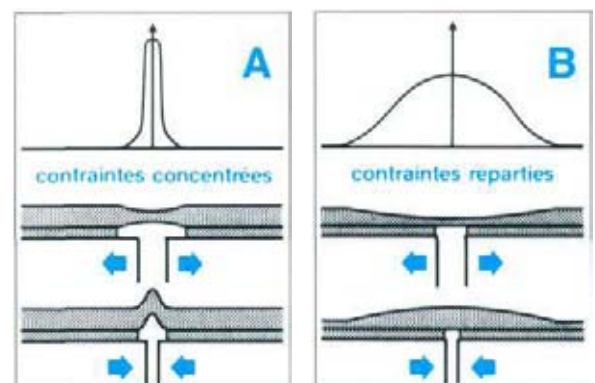

Soprema elastomeric membranes

Soprema performance
according to European Union
of Agreement:
No cracking from new (- 15° C)
and during ageing over 6 months (0° C).

SOPREMA SBS MEMBRANES

► POUR AND ROLL

- Elastophene Sanded
Glass fleece base Sanded facings
- Elastophene 180 Sanded
Non-woven polyester base - Sanded facings
- Elastophene GR or ARD
Glass fleece base - Coloured mineral granules (GR) or slate chippings (ARD) on top surface
- Sopralene 250 Sanded
Non-woven polyester base - Sanded facings
- Sopralene 250 GR
Non-woven polyester base Coloured mineral granules (GR) on top surface
- Sopralene 350 Sanded
Non-woven polyester base - Sanded facings
- Sopralene 350 GR
Non-woven polyester base Coloured mineral granules on top surface

► TORCH-ON

- Elastophene Flam
Glass fleece base • Both sides protected by thermofusible plastic film
- Elastophene Flam GR
or ARD
Glass fleece base • Underside protected by thermofusible plastic film. Coloured mineral granules (GR) or slate chippings (ARD) on top surface.
- Sopralene Flam 180
Non-woven polyester base • Both sides protected by thermofusible plastic film
- Sopralene Flam 180 GR
or ARD
Non-woven polyester base • Underside protected by thermofusible plastic film. Coloured mineral granules (GR) or slate chippings (ARD) on top surface.
- Sopralene Flam 180 S4 GR
Non-woven polyester base • Underside protected by thermofusible plastic film. Coloured mineral granules (GR) on top surface.
- Sopralene Flam 250
Non-woven polyester base Both sides protected by thermofusible plastic film
- Sopralene Flam 250 GR
or ARD
Non-woven polyester base Underside protected by thermofusible plastic film. Coloured mineral granules (GR) or slate chippings (ARD) on top surface.
- Sopralast TV Alu, Inox or
Copper
Re-inforced glass fabric base Aluminium foil (Alu), stainless steel (Inox) or Copper foil on top surface.

COLOUR IT SOPREMA

Planning Authorities and environmental lobbies are ever more vigilant in their desire to achieve harmony with the areas surrounding new and renovated buildings.

The SOPREMA range has 8 colour finishes in natural granules or slate chippings. So effective are these that many buildings have been designed with roofs which make a feature of a combination of the colours.



Douala hospital Cameroon



Creteil city hall



Veronese green



Matisse brown

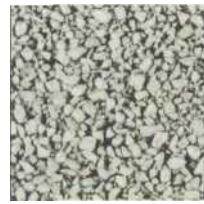

Chagall grey

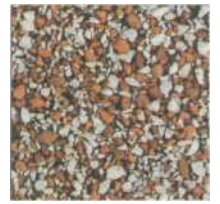

Cezanne sienna



Gauguin red



Van Gogh ochre



Grey slate



Black slate

Where a copper or silver effect is required, there are three metal facings available. These are invaluable where a metal roof has to be replaced or continued across an extension but where the cost of copper or aluminium is prohibitive. Specifying SOPRALAST TV in copper, aluminium or stainless steel can satisfy planning and aesthetic requirements at a sensible cost.



Mosque in Vancouver



Copper



Stainless steel

Natural Aluminium

	POUR AND ROLL							
	ELASTOPHENE				SOPRALENE			
	Sanded	180 sanded	GR	ARD	250 sanded	250 GR	350 sanded	350 GR
REINFORCEMENT	VV50g	PNT180g	VV50g	VV50g	PNT250g	PNT250g	PNT350g	PNT350g
ROLL LENGTH	15 m	15 m	10 m	10m	8 m	8 m	8 m	5 m
ROLL WIDTH	1m	1m	1m	1m	1m	1m	1m	1m
ROLLS PER PALLET	30	25	30	30	30	30	30	36
THICKNESS overall	2.2 mm	2,2 mm	-	-	4,0 mm	4,0 mm	4,0 mm	5,0 mm
on overlap	-	-	2.3 mm	2,3 mm	-	-	-	-
NOMINAL WEIGHT per m ²	2.8 kg	2.9 kg	4,0kg	3.6 kg	5 kg	4,9 kg	5 kg	6,2 kg
per roll	42 kg	44 kg	40 kg	36kg	40 kg	39kg	40 kg	31kg
TENSILE: strength at break N/5 cm L/T	250/150	750/500	250/150	250/150	800/800	800/800	900/900	900/900
NF G 07001 elongation at break	2 %	40%	2 %	2 %	40%	40%	45 %	45 %
LOW TEMPERATURE FLEXIBILITY UEAtc*	-15° C	-15° C	-15° C	-15° C	-15° C	-15° C	-15° C	-15° C
HEAT RESISTANCE UEAtc*	> 100° C	> 100° C	> 100° C	> 100° C	> 100° C	> 100° C	> 100° C	> 100° C
TEARING STRENGTH UEAtc*	-	200 N	-	-	300 N	300 N	320 N	320 N
FREE SHRINKAGE UEAtc*	< 1 %	<5 %	< 1 %	< 1 %	<5 %	<5 %	<5 %	<5 %

•according to UEAtc general directive (M.O.A.T. n° 27:1983) and UEAtc special directive (M.O.A.T. n° 31:1984)

**NF P 84 340

GR : mineral finish

ARD: slate chippings

W : glass fleece

PNT : non woven polyester

TV : glass fabric

	TORCH-ON									
	SLASTOPHENE					SOPRALENE				
	Flam	Flam GR	Flam ARD	Flam 180	Flam 180 GR	Flam 180 ARD	Flam 180 S4 GR	Flam 250	Flam 250 GR	Flam 250 ARD
REINFORCEMENT	VV50g	VV50g	VV50g	PNT180g	PNT180g	PNT180g	PNT180g	PNT250g	PNT250g	PNT250g
ROLL LENGTH	10m	10 m	10 m	10 m	8m	8m	5 m	8m	5 m	5 m
ROLL WIDTH	1m	1m	1m	1m	1m	1m	1m	1m	1m	1m
ROLLS PER PALLET	30	30	30	30	30	30	36	30	36	36
THICKNESS overall	3,0 mm	-	-	3,0 mm	4,0 mm	4,0 mm	-	4,0 mm	-	-
on overlap	-	2,3 mm	2,3 mm	-	-	-	4,0 mm	-	4,0 mm	4,0 mm
NOMINAL WEIGHT per m ²	3,8 kg	3,95 kg	3,5 kg	3,7 kg	5,0 kg	5,0 kg	6,2 kg	4,7 kg	6,1 kg	5,6 kg
per roll	38kg	39,5kg	35kg	37 kg	40 kg	40 kg	31 kg	38kg	30,5 kg	28kg
TENSILE: strength at break N/5 cm L/T	300/200	300/200	300/200	750/500	750/500	750/500	750/500	800/700	800/700	800/700
NF G 07001 elongation at break	2 %	2 %	2 %	40%	40%	40%	40%	50%	50%	50%
LOW TEMPERATURE FLEXIBILITY UEAtc*	-20° C	-20° C	-20° C	-20° C	-20° C	-20° C	-20° C	-20° C	-20° C	-20° C
HEAT RESISTANCE UEAtc*	> 100° C	> 100° C	> 100° C	> 100° C	> 100° C	> 100° C	> 100° C	>100° C	> 100° C	> 100° C
TEARING STRENGTH UEAtc*	-	-	-	200 N	200 N	200 N	300 N	320 N	320N	320 N
FREE SHRINKAGE UEAtc*	<1 %	<1 %	<1 %	<5 %	<5 %	<5 %	<5 %	<5 %	<5 %	<5 %

•according to UEAtc general directive (M.C)

**NF P 84 340

GR : mineral finish

ARD: slate chippings

VV : glass fleece

PNT : non woven polyester

TV : glass fabric

	ANCILLARY PRODUCTS				
	SOPRALAST				
	Aerisol	Aerisol Flam	Alu	Copper	Inox
REINFORCEMENT	VV60g	VV60g	TV52g	TV52g	TV52g
ROLL LENGTH	10 m	15 m	10 m	10 m	8 m
ROLL WIDTH	1 m	1 m	1 m	1 m	1 m
ROLLS PER PALLET	30	36	25	25	25
THICKNESS overall	-	1,4 mm	-	-	-
on overlap	-	-	3,3 mm	3,1 mm	3,5 mm
NOMINAL WEIGHT per m ²	2,6 kg	1,5 kg	4,4 kg	4,2 kg	5 kg
per roll	26 kg	23 kg	44 kg	42 kg	40 kg
TENSILE: strength at break N/5 cm L/T	-	-	>600 N		
NF G 07001 elongation at break	-	-	>3 %		
LOW TEMPERATURE FLEXIBILITY UEAtc*	-	-	-10° C		
HEAT RESISTANCE UEAtc*	-	-	>80°C**		
TEARING STRENGTH UEAtc*	-	-	-		
FREE SHRINKAGE UEAtc*	-	-	< 2 %**		

•according to UEAtc general directive (M.O.)

**NF P 84 340

GR : mineral finish

ARD: slate chippings

VV : glass fleecce

PNT : non woven polyester

TV : glass fabric

DETAILS FOR SPECIFYING SOPREMA MEMBRANES

The following drawings show how SOPREMA SBS membranes can be specified for flat roofs. Where insulation is included, reference should also be made to the manufacturer's recommendations. ELASTOPHENE and SOPRALENE membranes are installed by conventional pour and roll method. ELASTOPHENE FLAM and SOPRALENE FLAM are torched on, eliminating heavy and dangerous equipment on the roof and ensuring the correct quality and quantity of SBS bitumen. SOPREMA (UK) Limited will be pleased to provide design and site assistance.

WARM ROOF METAL DECK

- | | |
|---|------------------------|
| TORCH ON | POUR & ROLL |
| Use either chippings or cap sheet with MINERAL (grans) or SLATE (ardoise) finish | |
| ELASTOPHENE FLAM | ELASTOPHENE |
| SOPRALENE FLAM 180 | ELASTOPHENE 180 SANDED |
| PERFORATED FELT/VENT LAYER | |
| INSULATION | |
| VAPOUR BARRIER | |
| PRIMER | |
| METAL DECK galvanized steel or aluminium can be upgraded by use of SOPRALENEFLAM 180 or 250 | |
| | SOPRALENE 250 or 350 |

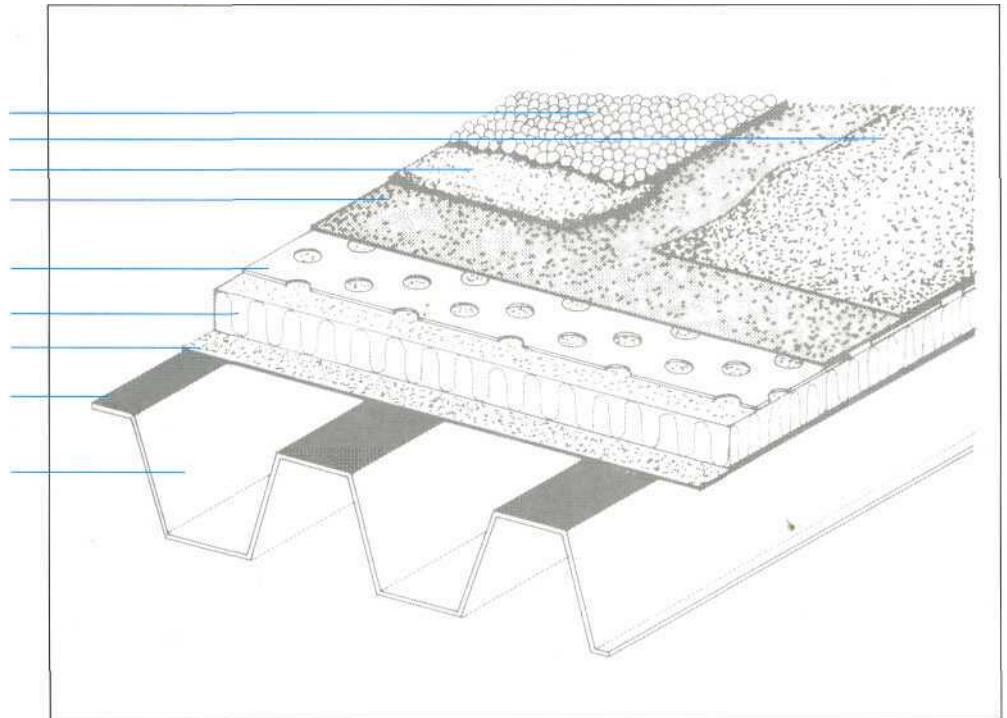

METAL-DECK OUTLET

- | | |
|---|------------------------|
| TORCH ON | POUR & ROLL |
| ELASTOPHENEFLAM | ELASTOPHENE |
| SOPRALENE FLAM 180 | ELASTOPHENE 180 SANDED |
| PERFORATED FELT/VENT LAYER | |
| INSULATION | |
| VAPOUR BARRIER | |
| PRIMER | |
| METAL DECK galvanized steel or aluminium can be upgraded as above | |

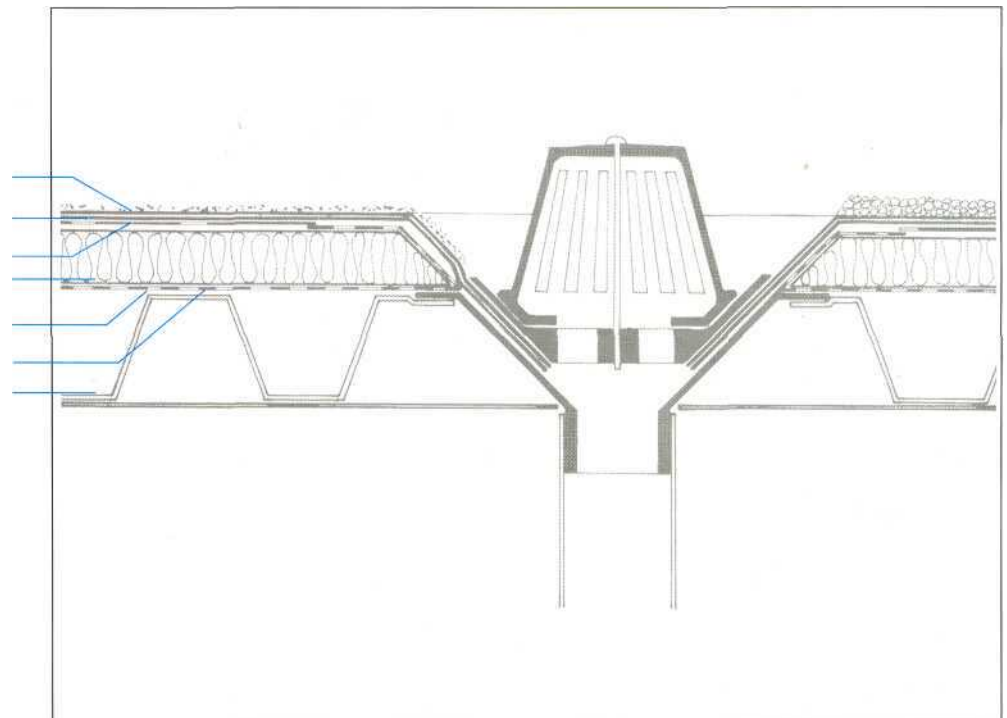

WARM ROOF CONCRETE DECK

TORCH ON

Use either chippings or cap sheet with
MINERAL (grans) or SLATE (ardoise) finish

ELASTOPHENE FLAM
SOPRALENE FLAM 180

POUR & ROLL

ELASTOPHENE
ELASTOPHENE 180 SANDED

PERFORATED FELT/VENT LAYER

INSULATION

VAPOUR BARRIER

PRIMER

SCREED TO FALLS

CONCRETE DECK

CEILING

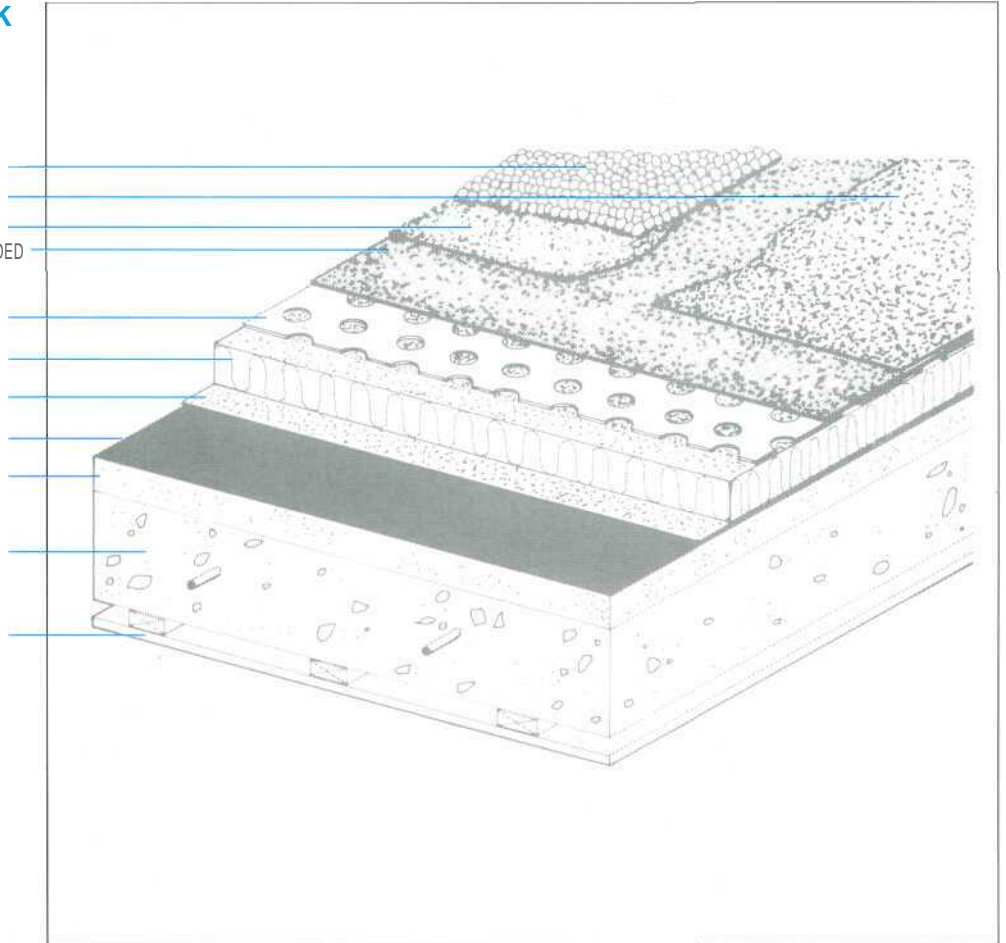

can be upgraded by use of
SOPRALENE FLAM
180 or 250

SOPRALENE
250 or 350

UPSTAND DETAIL

METAL FLASHING (OPTIONAL)

CHASE 25 mm x 25 mm minimum
4:1 MIX SAND CEMENT
POINTING

MINERAL FELT

TORCH ON

ELASTOPHENE FLAM
SOPRALENE FLAM 180

POUR & ROLL

ELASTOPHENE
ELASTOPHENE 180 SANDED

PERFORATED FELT/VENT LAYER

INSULATION

VAPOUR BARRIER/CHECK

PRIMER

SCREED TO FALLS

CONCRETE DECK

CEILING

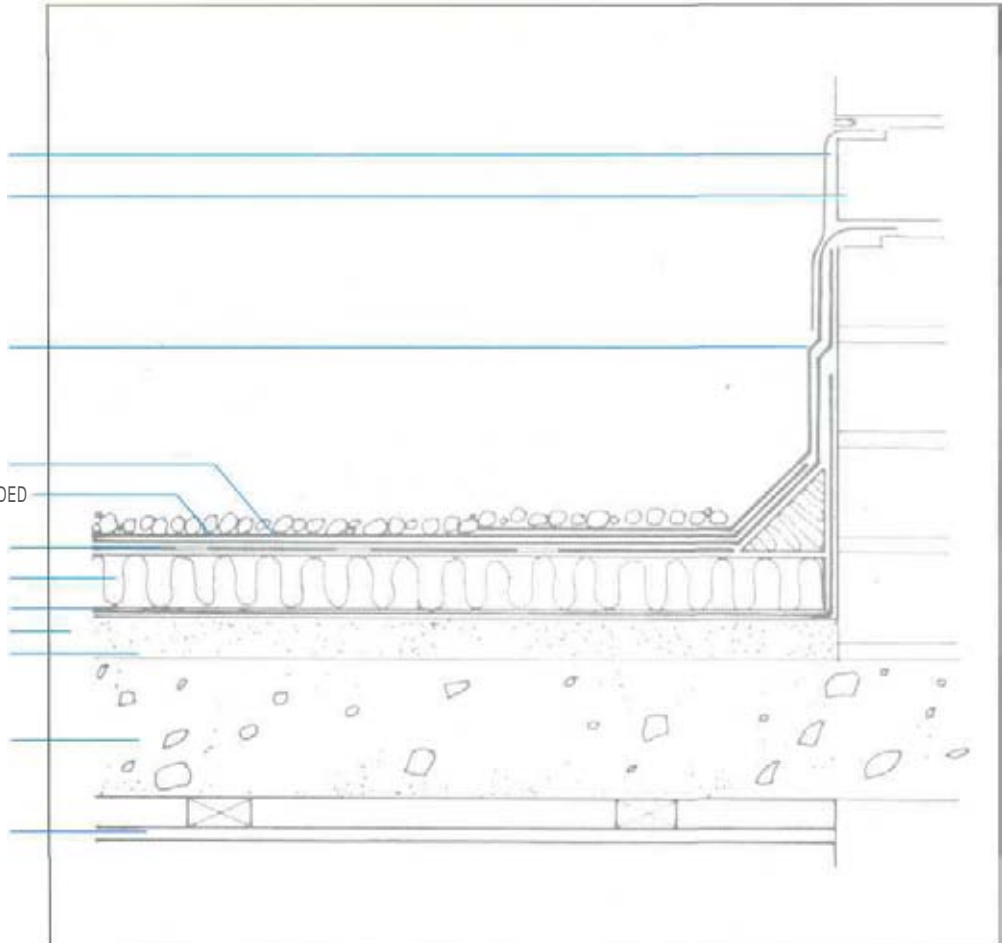

can be upgraded as above

WARM ROOF

PLYWOOD OR PARTICLE BOARD DECK

TORCH ON

Use either chippings or cap sheet with MINERAL (grans) or SLATE (ardoise) finish

ELASTOPHENE FLAM

SOPRALENE FLAM 180

POUR & ROLL

Use either chippings or cap sheet with MINERAL (grans) or SLATE (ardoise) finish

ELASTOPHENE

ELASTOPHENE 180 SANDED

PERFORATED FELT/VENT LAYER

INSULATION

VAPOUR BARRIER/CHECK

TYPE 2B FELT RANDOM NAILED

TIMBER DECK

CEILING

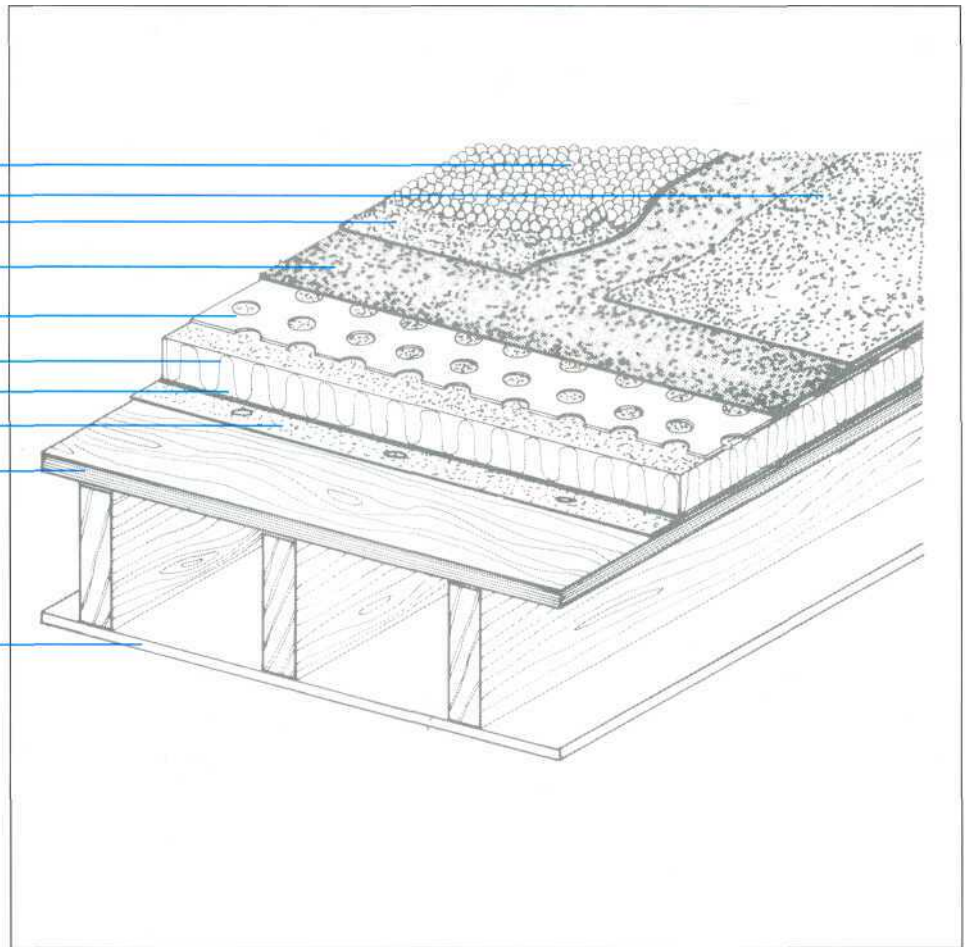

can be upgraded by use of
SOPRALENE FLAM
180 or 250

SOPRALENE
250 or 350

EDGE DETAIL - WELTED DRIP

TORCH ON

Use either chippings or cap sheet with MINERAL (grans) or SLATE (ardoise) finish

ELASTOPHENE FLAM

SOPRALENE FLAM 180

POUR & ROLL

Use either chippings or cap sheet with MINERAL (grans) or SLATE (ardoise) finish

ELASTOPHENE

ELASTOPHENE 180 SANDED

MINERAL FELT

TIMBER BATTEN MINIMUM 25 x 50 mm

PERFORATED FELT/VENT LAYER

INSULATION

VAPOUR BARRIER/CHECK

TYPE 2B FELT RANDOM NAILED

TIMBER DECK

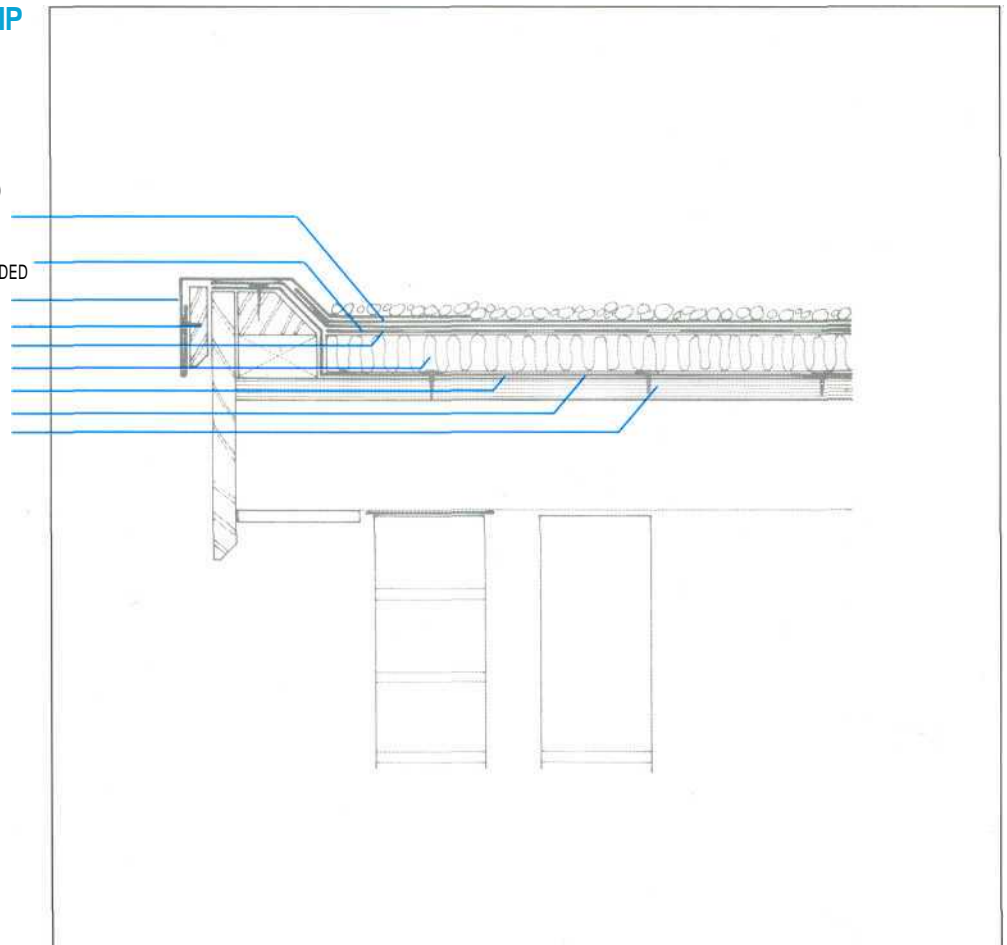

can be upgraded as above

INVERTED OR UPSIDE DOWN ROOF CONCRETE DECK

TORCH ON
Concrete paviors or
19 mm minimum washed AGGREGATE laid loose

POUR & ROLL
50 mm depth of
Optional layer of polythene

Closed cell insulation e.g.
EXTRUDED POLYSTYRENE laid loose

ELASTOPHENE FLAM ELASTOPHENE

SOPRALENE FLAM 180 ELASTOPHENE 180 SANDED

PRIMER

SCREED TO FALLS

CONCRETE DECK

CEILING

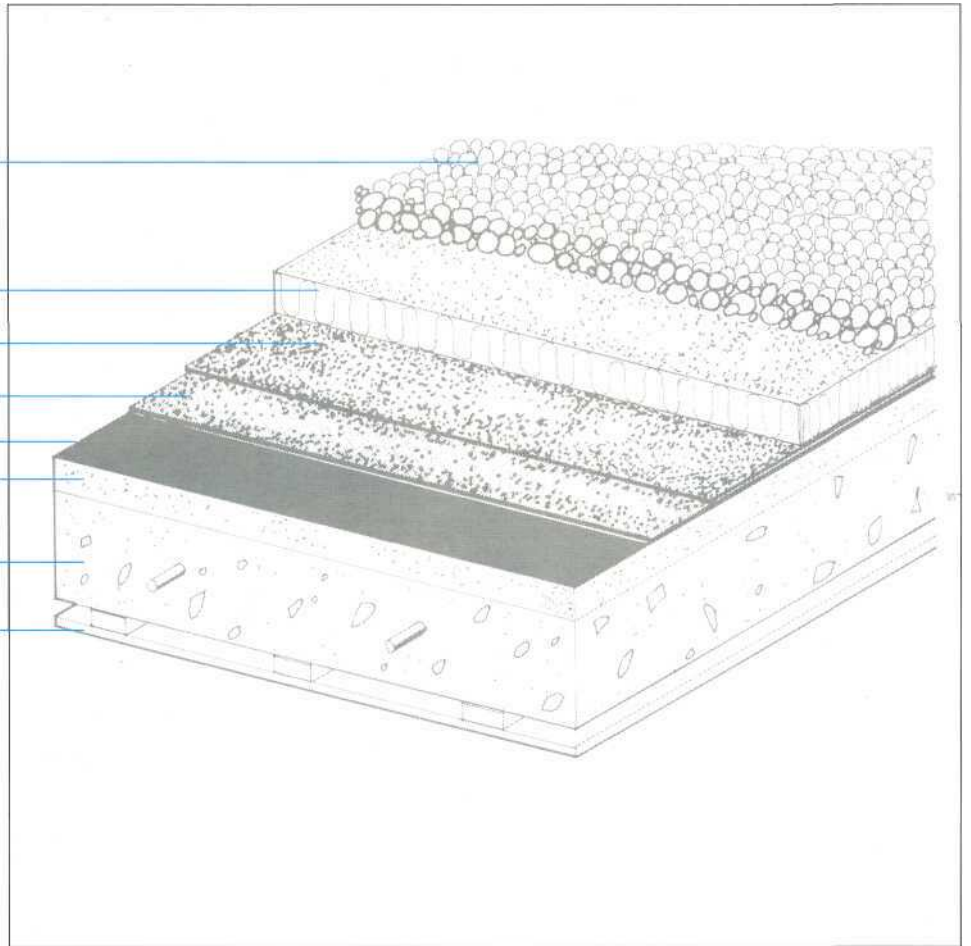

can be upgraded by used of
SOPRALENE FLAM SOPRALENE
180 or 250 250 or 350

INVERTED OR UPSIDE DOWN ROOF UPSTAND DETAIL

DPC

LEAD FLASHING

25 mm x 25 mm MINIMUM CHASE
e.g. POINT UP CHASE WITH
4:1 MIX SAND/CEMENT

MINERAL FELT

Concrete paviors or 50 mm depth of
19 mm minimum washed AGGREGATE laid loose
Optional layer of polythene
Closed cell insulation e.g.
EXTRUDED POLYSTYRENE laid loose

ELASTOPHENE FLAM ELASTOPHENE

SOPRALENE FLAM 180 ELASTOPHENE 180 SANDED

SCREED TO FALLS
CONCRETE DECK

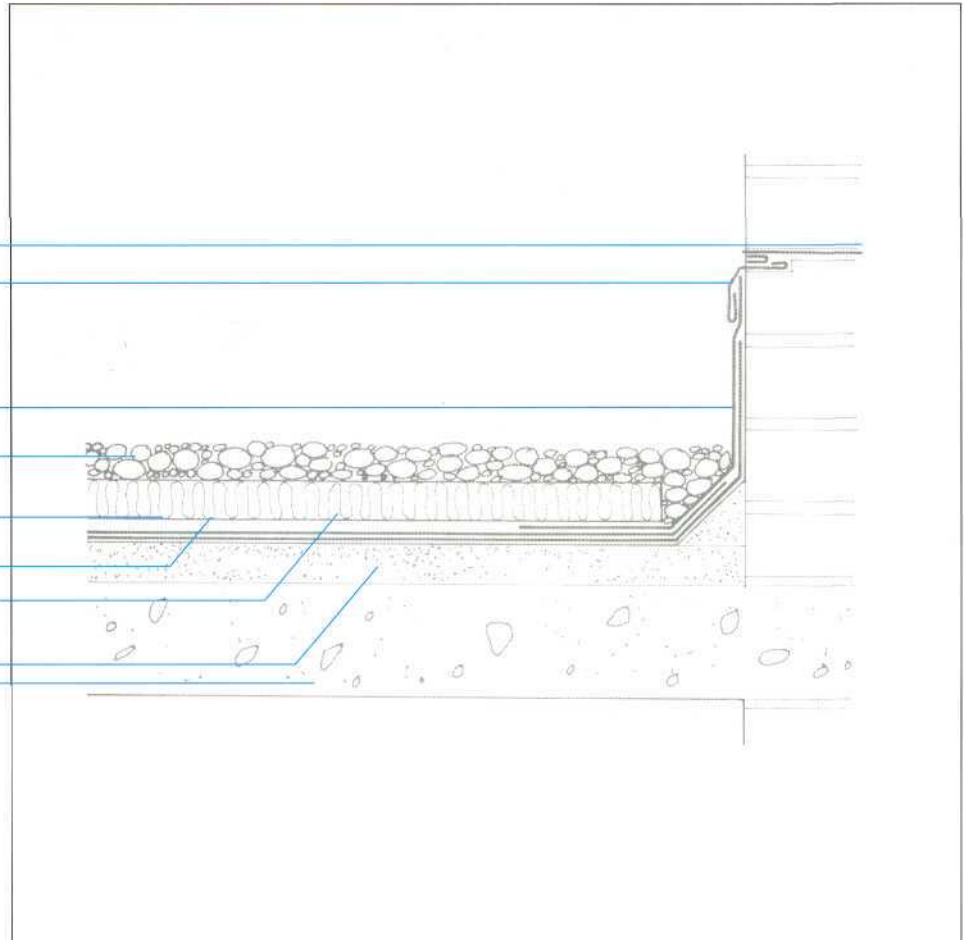

can be upgraded as above

ROOF TOP CAR PARKING (FOR CARS ONLY)

- POUR & ROLL**
 RE-INFORCED CONCRETE WEARING SURFACE
 APPROXIMATELY 70 mm
- POLYTHENE OR LAPPED UNBONDED
 WATERPROOF BUILDING PAPER TO BS15211
 LOOSE LAID ROOFING FELT SUCH AS
 ELASTOPHENE
- SOPRALENE ANTIROCK
 (LAID IN HOT BITUMEN)
- ELASTOPHENE 180 SANDED
 (LAID IN HOT BITUMEN)
- CELLULAR GLASS INSULATION
 (LAID IN HOT BITUMEN)
- BITUMEN-BASED PRIMER
- SCREED TO FALLS
- CONCRETE DECK

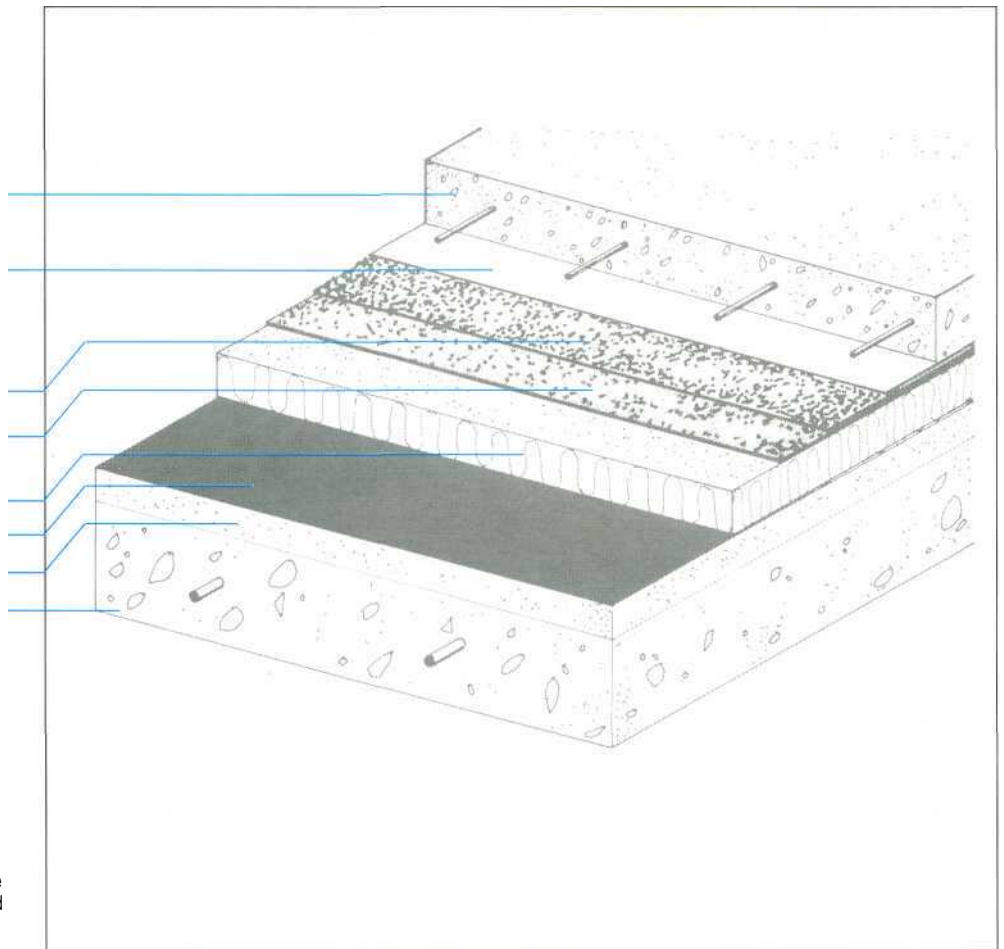

ALTERNATIVELY: Prime the concrete deck. Lay the membranes in hot bitumen directly on the concrete deck, then loose lay heavy-duty polystyrene, lapped unbonded paper or felt followed by re-inforced wearing surface.

COLD ROOF TIMBER DECK

- TORCH ON** **POUR & ROLL**
 Use either chippings or cap sheet with
 MINERAL (grans) or SLATE (ardoise) finish
 ELASTOPHENE FLAM ELASTOPHENE
- SOPRALENE FLAM 180 ELASTOPHENE 180 SANDED
- 1st LAYER TYPE 2B FELT RANDOM NAILED
- TIMBER BOARDED DECK LAID TO FALLS
- CAVITY VENTILATED TO OUTSIDE AIR
- INSULATION
- VAPOUR CHECK NORMALLY REQUIRED
 UNDER INSULATION
 SUSPENDED CEILING

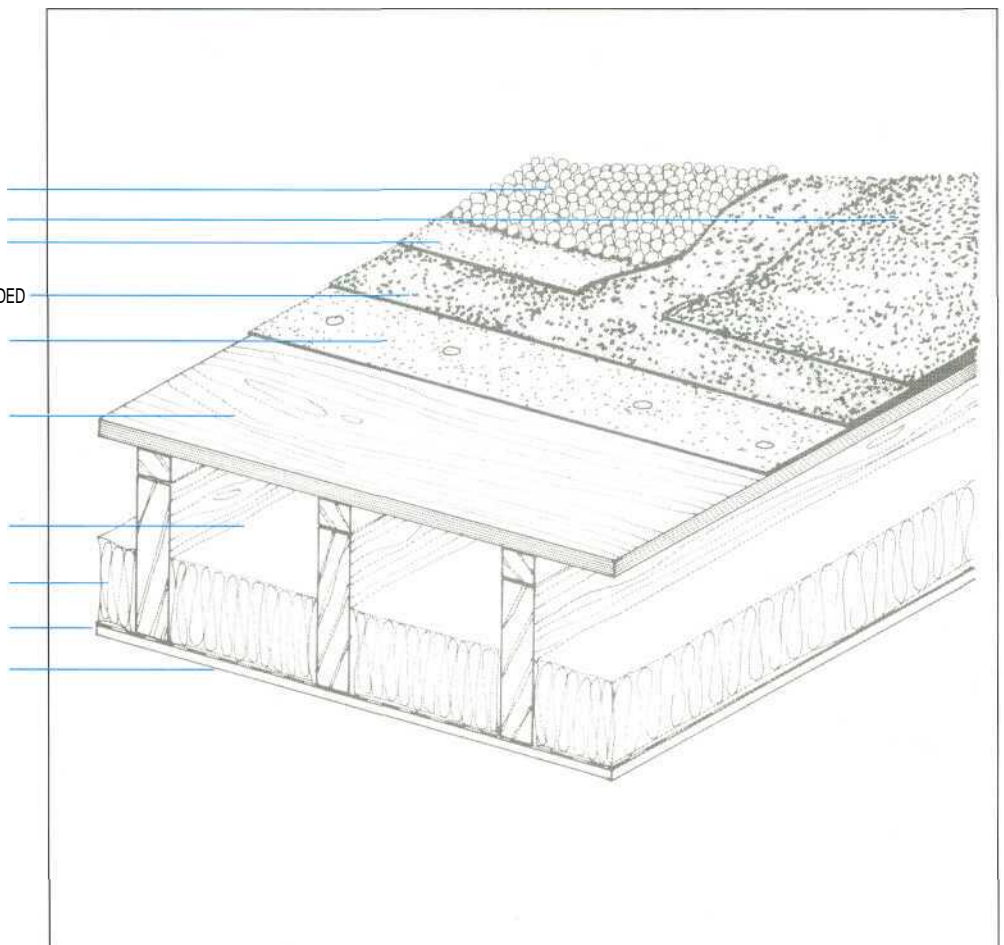

can be upgraded by use of
 SOPRALENE FLAM
 180 or 250

SOPRALENE
 250 or 350

ADDITIONAL WARM ROOF DETAILS EDGE TRIM DETAIL

CHIPPINGS ALTERNATIVELY A MINERAL FINISH
MAY BE CONSIDERED

ELASTOPHENE FLAM ELASTOPHENE

SOPRALENE FLAM 180 ELASTOPHENE 180 SANDED

MINERAL/SLATE FELT
TRIM

PERFORATED FELT/VENT LAYER
INSULATION

2nd LAYER VAPOUR BARRIER/CHECK
1st LAYER 2B TYPE FELT RANDOM NAILED

TIMBER BOARDED DECK

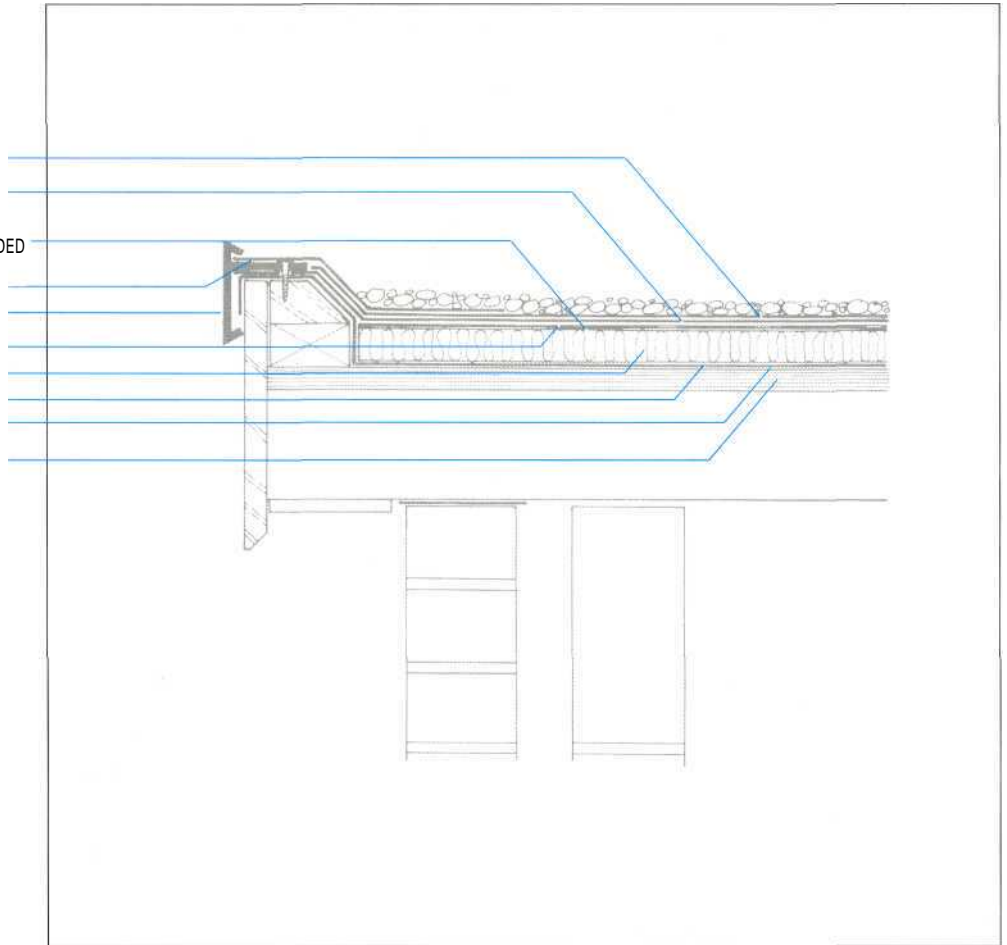

can be upgraded by use of
SOPRALENE FLAM SOPRALENE
180 or 250 250 or 350

WELTED DRIP AND GUTTER DETAIL

CHIPPINGS ALTERNATIVELY A MINERAL FINISH
MAY BE CONSIDERED

ELASTOPHENE FLAM ELASTOPHENE

SOPRALENE FLAM 180 ELASTOPHENE 180 SANDED

MINERAL/SLATE FELT

PERFORATED FELT/VENT LAYER

TIMBER BATTEN MINIMUM 25 x 50 mm

2nd LAYER VAPOUR/BARRIER CHECK
1st LAYER 2B TYPE FELT RANDOM NAILED

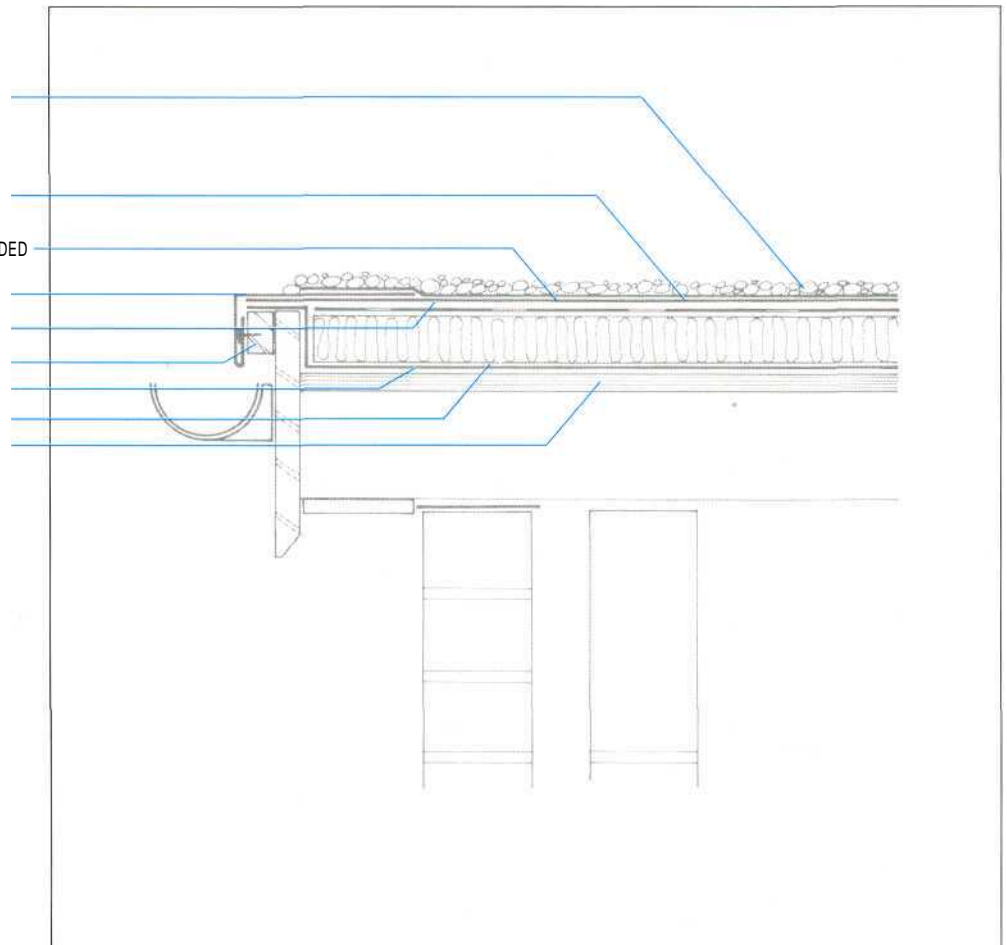

TIMBER BOARDED DECK



can be upgraded as above

STRONG PRODUCTS WITH STRONG GUARANTEES

10-year insurance-backed guarantee available through Approved Roofing Contractors gives cover.

- CERTIFICATE OF INSURANCE -

This is to certify that Liability Policy n° 9498645 has been issued by UNI EUROPE, 24 rue Drouot 75009 PARIS, to :

SOPREMA
14 rue de Saint Nazaire
67000 STRASBOURG

and is in force at this time.

Said policy insures the pecuniary consequences of the assured's legal liability in relation with any damage caused to third parties by defective products or recommendations, after delivery.

This coverage applies to the repair costs the insured shall become obligated to pay by reason of defective delivered products, except for the replacing products themselves, which will be supplied by the insured.

Amounts of coverage

- Bodily, material and consequential intangible damage (including replacement costs of products) coverage per loss and annual aggregate..... : FF 7.000.000,-
- including non consequential intangible damage..... : FF 1.500.000,-

Deductible : 10 % but not less than FF 7.000,- nor more than FF 35.000,-

Said coverage applies worldwide, and in particular in UNITED KINGDOM and THE REPUBLIC OF IRELAND, but except in the UNITED STATES OF AMERICA and CANADA (and FRANCE only for the replacement costs of products).

THE INSURANCE AFFORDED BY SAID POLICY IS SUBJECT TO ALL THE TERMS, EXCLUSIONS AND CONDITIONS OF THE POLICY, AND THIS CERTIFICATE DOES NOT AMEND, EXTEND OR ALTER THE COVERAGE AFFORDED BY THE POLICY LISTED ABOVE.

Only French Law applies to present policy.

Date issued : January 19, 1989



groupe RCB
7, rue de Naples
75008 PARIS
Tél. (1) 43.87.45.29
Télex 650 426 RCB F
Télécopieur (Fax) : (1) 43.87.42.51



groupe RCB
7, rue de Naples - 75008 Paris
Tél. (1) 43.87.45.29

Société Anonyme au Capital de 250 000 Francs - R.C. Paris 78 9 3429 - A.P.E. 7802 - SIRET 312 994 940 0038

Registered n°

WARRANTY



following materials :

covered by order dated _____ for the following project :

Owner: _____

Roofing or waterproofing company: _____

for _____ years on the following terms :

- Said supplies are warranted to conform to our specifications and to be free from defect.
- In event of trouble during the work or within _____ years of the date of delivery, SOPREMA S.A. will supply the replacement materials without charge (if the trouble is due to the materials themselves) and will assume the cost of removal and of installation of its new materials, to the exclusion of any other work.
- If the warranted materials are no longer manufactured by SOPREMA S.A., SOPREMA S.A. reserves the right to supply other materials of its manufacture compatible with the repair to be made.

This warranty may be enforced only if the purchaser has paid SOPREMA S.A. for its purchases in full.

The warranty does not cover trouble caused by defective use or by improper design of the project work or structure.

The company shall inform SOPREMA S.A. within eight days of the occurrence of trouble which may be covered by this warranty and shall make no definitive repair before examination of the terrace and development of the solution by SOPREMA S.A.

Signed in Strasbourg, on _____

Soprema Product Warranty gives 10-year protection against the possibility of product defects.

SOPREMA REFERENCES

▼ Creteil city hall

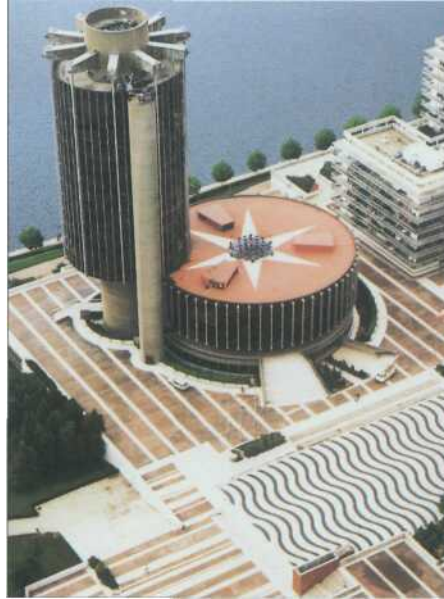

▼ Eiffel tower-Paris. Waterproofing of 2nd floor.



▼ Bouuges Clamart



▼ Shopping Centre Maine Le Mans



▼ Bridge-Iceland



▼ Edmonton - Canada



▼ Reunion Island



▼ Ottawa-Canada



SOPREMA®

SOPREMA (UK) LIMITED, 217 LONDON ROAD
APSLEY, HEMEL HEMPSTEAD, HERTS HP3 9SE, UK.
TEL. (0442) 219421/2 – FACSIMILE (0442) 219491

